

## SQUARE STEP DRILL ("G") COOLANT FED

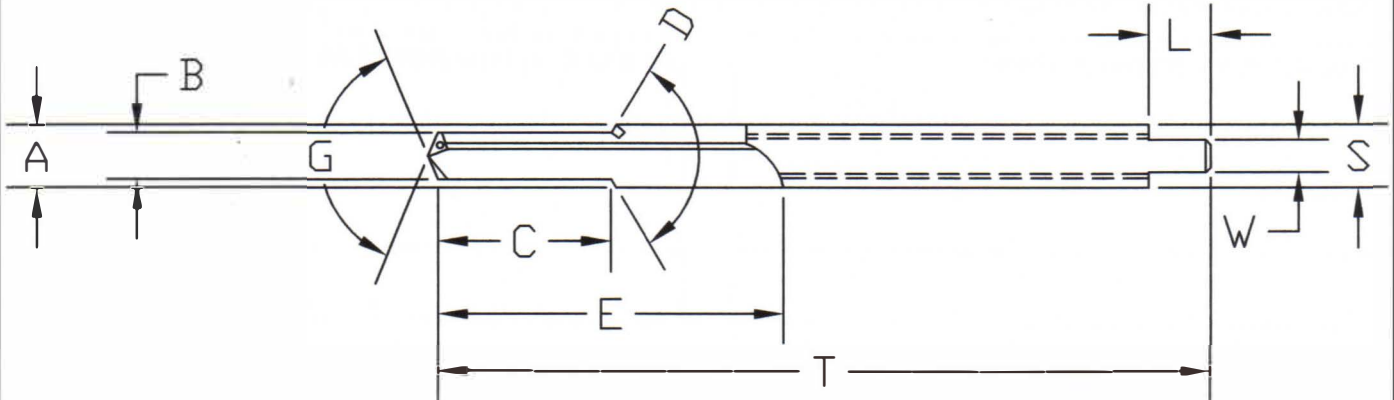

A= \_\_\_\_\_ LARGE DIAMETER  
 B= \_\_\_\_\_ SMALL DIAMETER  
 C= \_\_\_\_\_ STEP LENGTH  
 D= \_\_\_\_\_ STEP ANGLE (INCL.)  
 M= \_\_\_\_\_ MATERIAL TO BE CUT  
 S= \_\_\_\_\_ SHANK SIZE

E= \_\_\_\_\_ FLUTE LENGTH  
 L= \_\_\_\_\_ TANG LENGTH  
 W= \_\_\_\_\_ TANG THICKNESS  
 G= \_\_\_\_\_ POINT ANGLE  
 T= \_\_\_\_\_ OVERALL LENGTH  
 N= \_\_\_\_\_ HOLE STYLE #

"A" Tolerance (+.0000/-0.0005) Inches  
 "A" Tolerance (+.0.000/-0.013) Metric  
 "B" Tolerance (+.0005/-0.0005) Inches  
 "B" Tolerance (+.0.0127/-0.0127) Metric  
 "A" & "B" Backtaper (.0002/inch) Inches

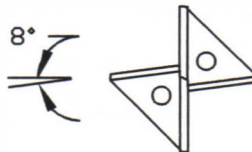

Standard Point Style  
 is a 135° (4) Facet  
 Unless Stated Otherwise

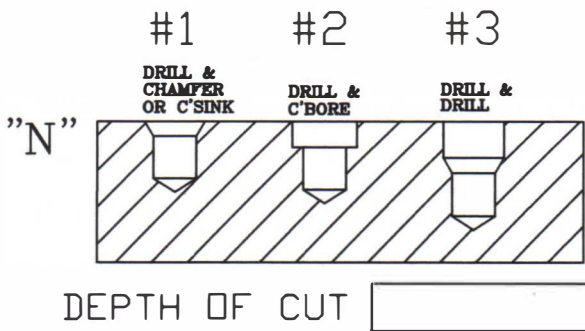

|                  |            |                          |
|------------------|------------|--------------------------|
| MATERIAL OF TOOL | CARBIDE    | <input type="checkbox"/> |
|                  | COBALT     | <input type="checkbox"/> |
|                  | H.S.S. M-7 | <input type="checkbox"/> |
| COATING NEEDED   | TIN        | <input type="checkbox"/> |
|                  | TICN       | <input type="checkbox"/> |
| OTHER COATING    |            | <input type="checkbox"/> |

PLEASE LIST ANY SPECIAL REQUIREMENTS NOT MENTIONED ABOVE:

800-535-HART TOLL-FREE  
 847-639-7555 FACSIMILE  
 www.hartlandtool.com